

KATANA®

BRUSHLESS
PERFORMANCE MOTOR

CORDLESS BRUSHLESS LINE TRIMMER & BRUSH CUTTER INSTRUCTION MANUAL

2x 18V CHARGE-ALL

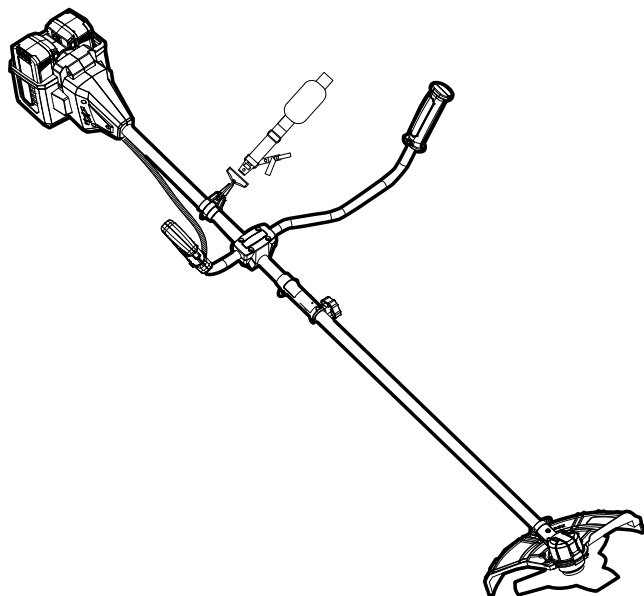

04/22

**5 YEAR
WARRANTY***

**2x 18V
LITHIUM ION**

220211

GENERAL POWER TOOL SAFETY WARNINGS

220211



WARNING Read all safety warnings and all instructions. Failure to follow the warnings and instructions may result in electric shock, fire and/or serious injury. **Save all warnings and instructions for future reference.** The term "power tool" in the warnings refers to your mains-operated (corded) power tool or battery-operated (cordless) power tool. The intended use is described in this manual. The use of any accessory or attachment or the performance of any operation with this appliance other than those recommended in this instruction manual may present a risk of personal injury.

1) Work area safety

- a) **Keep work area clean and well lit.** Cluttered or dark areas invite accidents.
- b) **Do not operate power tools in explosive atmospheres, such as in the presence of flammable liquids, gases or dust.** Power tools create sparks which may ignite the dust or fumes.
- c) **Keep children and bystanders away while operating a power tool.** Distractions can cause you to lose control
- d) **Never allow children or people unfamiliar with the instructions to use the appliance.** local regulations may restrict the age of the operator.

2) Electrical safety

- a) **Power tool plugs must match the outlet. Never modify the plug in any way. Do not use any adapter plugs with earthed (grounded) power tools.** Unmodified plugs and matching outlets will reduce risk of electric shock.
- b) **Avoid body contact with earthed or grounded surfaces, such as pipes, radiators, ranges and refrigerators.** There is an increased risk of electric shock if your body is earthed or grounded.
- c) **Do not expose power tools to rain or wet conditions.** Water entering a power tool will increase the risk of electric shock.
- d) **Do not abuse the cord. Never use the cord for carrying, pulling or unplugging the power tool. Keep cord away from heat, oil, sharp edges or moving parts.** Damaged or entangled cords increase the risk of electric shock.
- e) **When operating a power tool outdoors, use an extension cord suitable for outdoor use.** Use of a cord suitable for outdoor use reduces the risk of electric shock.
- f) **If operating a power tool in a damp location is unavoidable, use a residual current device (RCD) protected supply.** Use of an RCD reduces the risk of electric shock.

3) Personal safety

- a) **Stay alert, watch what you are doing and use common sense when operating a power tool. Do not use a power tool while you are tired or under the influence of drugs, alcohol or medication.** A moment of inattention while operating power tools may result in serious personal injury.
- b) **Use personal protective equipment. Always wear**

eye protection. Protective equipment such as dust mask, non-skid safety shoes, hard hat, or hearing protection used for appropriate conditions will reduce personal injuries.

- c) **Prevent unintentional starting. Ensure the switch is in the off-position before connecting to power source and/or battery pack, picking up or carrying the tool.** Carrying power tools with your finger on the switch or energising power tools that have the switch on invites accidents.
- d) **Remove any adjusting key or wrench before turning the power tool on.** A wrench or a key left attached to a rotating part of the power tool may result in personal injury.
- e) **Do not overreach. Keep proper footing and balance at all times.** This enables better control of the power tool in unexpected situations.
- f) **Dress properly. Do not wear loose clothing or jewelry. Keep your hair, clothing and gloves away from moving parts.** Loose clothes, jewelry or long hair can be caught in moving parts.
- g) **If devices are provided for the connection of dust extraction and collection facilities, ensure these are connected and properly used.** Use of dust collection can reduce dust-related hazards.

4) Power tool use and care

- a) **Do not force the power tool. Use the correct power tool for your application.** The correct power tool will do the job better and safer at the rate for which it was designed.
 - b) **Do not use the power tool if the switch does not turn it on and off.** Any power tool that cannot be controlled with the switch is dangerous and must be repaired.
 - c) **Disconnect the plug from the power source and/or the battery pack from the power tool before making any adjustments, changing accessories, or storing power tools.** Such preventive safety measures reduce the risk of starting the power tool accidentally.
 - d) **Store idle power tools out of the reach of children and do not allow persons unfamiliar with the power tool or these instructions to operate the power tool.** Power tools are dangerous in the hands of untrained users.
 - e) **Maintain power tools. Check for misalignment or binding of moving parts, breakage of parts and any other condition that may affect the power tool's operation. If damaged, have the power tool repaired before use.** Many accidents are caused by poorly maintained power tools.
 - f) **Keep cutting tools sharp and clean.** Properly maintained cutting tools with sharp cutting edges are less likely to bind and are easier to control.
 - g) **Use the power tool, accessories and tool bits etc. in accordance with these instructions, taking into account the working conditions and the work to be performed.** Use of the power tool for operations different from those intended could result in a hazardous situation.
- 5) Battery tool use and care
- a) **Recharge only with the charger specified by the**

- manufacturer. A charger that is suitable for one type of battery pack may create a risk of fire when used with another battery pack.
- b) **Use power tools only with specifically designated battery packs.** Use of any other battery packs may create a risk of injury and fire.
- c) **When battery pack is not in use, keep it away from other metal objects, like paper clips, coins, keys, nails, screws or other small metal objects, that can make a connection from one terminal to another.** Shorting the battery terminals together may cause burns or a fire.
- d) **Under abusive conditions, liquid may be ejected from the battery; avoid contact. If contact accidentally occurs, flush with water. If liquid contacts eyes, additionally seek medical help.** Liquid ejected from the battery may cause irritation or burns.
- 6) Service
- a) **Have your power tool serviced by a qualified repair person using only identical replacement parts.** This will ensure that the safety of the power tool is maintained.
- 7) **Battery Tool Use And Care**
 Recharge only with the charger specified by the manufacturer. A charger that is suitable for one type of battery pack may create a risk of fire when used with another battery pack.
- a) **Use power tools only with specifically designated battery packs.** Use of any other battery packs may create a risk of injury and fire.
- b) **When battery pack is not in use, keep it away from other metal objects, like paper clips, coins, keys, nails, screws or other small metal objects, that can make a connection from one terminal to another.** Shorting the battery terminals together may cause burns or a fire.
- c) **Under abusive conditions, liquid may be ejected from the battery; avoid contact. If contact accidentally occurs, flush with water. If liquid contacts eyes, additionally seek medical help.** Liquid ejected from the battery may cause irritation or burns.
- d) **Prevent unintentional starting. Ensure the switch is in the off-position before installing a battery pack, picking up or carrying the tool.** Carrying the tool with your finger on the switch or energising the tool that have the switch on invites accidents.
- e) **Do not dispose of the battery(ies) in a fire.** The cell may explode. Check with local codes for possible special disposal instructions.
- f) **Do not open or mutilate the battery(ies).** Released electrolyte is corrosive and may cause damage to the eyes or skin. It may be toxic if swallowed.
- g) **Do not charge battery in rain, or in wet locations.**
- h) **Avoid dangerous environment. Don't use the tool in dump or wet locations or expose it to rain.** Water entering the tool will increase the risk of electric shock.
- i) **Do not charge the battery outdoors.**
- j) **Do not handle charger, including charger plug, and charger terminals with wet hands.**
- k) **Do not replace the battery with wet hands.**
- l) **Do not replace the battery in the rain.**
- m) **Do not wet the terminal of battery with liquid such as water, or submerge the battery.** Do not leave the battery in the rain, nor charge, use, or store the battery in a damp or wet place. If the terminal gets wet or liquid enters inside of battery, the battery may be short circuited and there is a risk of overheat, fire, or explosion.
- n) **After removing the battery from the tool or charger, be sure to attach the battery cover to the battery and store it in a dry place.**
- o) **If the battery cartridge gets wet, drain the water inside and then wipe it with a dry cloth.** Dry the battery cartridge completely in a dry place before use.
- p) **When you use the tool on muddy ground, wet slope, or slippery place, pay attention to your footing.**
- 8) **Grass Trimmers, Brush Cutters and Brush saw safety warnings.**
- a) **Do not use the machine in bad weather conditions, especially when there is risk of lightning.** This decreases the risk of being struck by lightning.
- b) **Thoroughly inspect the area for wildlife where the machine is to be used.** Wildlife may be injured by the machine during operation.
- c) **Thoroughly inspect the area where the machine is to be used and remove all stones, sticks, wires, bones and other foreign objects.** Thrown objects can cause personal injury.
- d) **Before using the machine, always visually inspect to see that the cutter or blade and the cutter or blade assembly are not damaged.** Damaged parts can cause personal injury.
- e) **Follow instructions for changing accessories.** Improperly tighten blade securing nuts or bolts may either damage the blade or result in it becoming detached.
- f) **The rated rotational speed of the blade must be at least equal to the maximum rotational speed marked on the machine.** Blades running faster than their rated rotational speed can break and fly apart.
- g) **Wear eye, ear, head and hand protection.** Adequate protective equipment will reduce personal injury by flying debris or accidental contact with the cutting line or blade.
- h) **Why operating the machine, always wear non-slip and protective footwear. Do not operate the machine barefoot or wearing open sandals.** This reduces the chance of injury to the feet from contact with the moving cutters or lines.
- i) **While operating the machine, always wear long trousers.** Exposed skin increases the likelihood of injury.
- j) **Keep bystanders, children and pets 15 m away from the area of operation, stop the product if anyone enters the area.** Thrown debris can result in serious personal injury.
- k) **Always use two hands when operating the machine.** Holding the machine with both hands will avoid loss of control.

- l) **Hold the machine by insulated gripping surfaces only, because the cutting line or blade may contact hidden wiring or it's own cord.** *Cutting line or blades contacting a "live" wire may expose metal parts of the machine "live" and could give the operator an electric shock.*
- m) **Always keep proper footing and operate the machine only when standing on the ground.** *Slippery or unstable surfaces may cause a loss of balance or control of the machine.*
- n) **Do not operate the machine on excessively steep slopes.** *This reduces the risk of slipping and falling which may result in personal injury.*
- o) **When working on slopes, always be sure of your footing, always work across the face of the slopes, never up or down and exercise extreme caution when changing direction.** *This reduces the risk of loss of control, slipping and falling which may result in personal injury.*
- p) **Keep all parts away from all parts of the body away from the cutter, line or blade when the machine is operating. Before you start the machine, make sure the cutter, line or blade is not contacting anything.** *A moment of inattention while operating the machine may result in injury to yourself or others.*
- q) **Do not operate the machine above waist height.** *This helps prevent unintended cutter contact and enables better control of the machine in unexpected situations.*
- r) **Do not operate the machine above waist height.** *This helps prevent unintended cutter or blade contact and enables better control of the machine in unexpected situations*
- s) **When cutting brush saplings that are under tension, be alert for spring back.** *When the tension in the wood fibres is released, the brush or sapling may strike the operator and/or throw the machine out of control.*
- t) **Use extreme caution when cutting brush and saplings.** *The slender material may catch the blade and be whipped toward you or pull off balance.*
- u) **Maintain control the machine and do not touch cutters, lines or blade or blades and other hazardous moving parts while they are still in motion.** *This reduces the risk of injury from moving parts.*
- v) **When clearing jammed material or servicing the machine, make sure all power switches are off and the power cord is disconnected.** *Unexpected starting of the machine while clearing jammed material or servicing may result in serious personal injury.*
- w) **Carry the machine with the machine switched off and away from your body.** *Proper handling of the machine will reduce the likelihood of accidental contact with a moving cutter, line or blade.*
- x) **When transporting or storing the machine, always fit the cover on metal blades.** *Proper handling of the machine will reduce the likelihood of accidental contact.*
- y) **Only replace cutters, lines, cutting heads and blades specified by the manufacture.** *Incorrect replacement parts may increase the risk of breakage and injury.*
- z) **Keep guards in place. Guards must be in working order and be properly mounted.** *A guard that is loose, damaged, or is not functioning correctly may result in personal injury.*
- a) **Never fit a metal replacement line.**
- ab) **Your brushcutter is fitted with a harness.** *Carefully adjust the harness to fit comfortably and help to support the weight of the machine at your right side.*
- ac) **Store the blade with the cardboard blade protector before storing the unit, or during transportation.** *Always remove the blade protector before using the unit. If not removed, the blade protector could become a thrown object as the blade begins to turn. Exercise extreme caution when using the blade with this product. Blade thrust is the reaction that may occur when the spinning blade contacts anything it cannot cut. This contact may cause the blade to stop for an instant, and suddenly "thrust" the unit away from the object that was hit. This reaction can be violent enough to cause the operator to lose control of the unit. Blade thrust may occur without warning if the blade snags, stalls, or binds. This is more likely to occur in areas where it is difficult to see the material being cut.*
- ad) **For cutting ease and safety, approach the weeds being cut from the right to the left.** *In the event that an unexpected object or woody stock is encountered, this practice could minimize the blade thrust reaction. Both hands must be used at all times to control this product.*

If the tool gets into one of the following situation, the tool automatically stops and the caution lamp starts blinking in green:

- The tool is overloaded by entangled weeds or other debris.
- The cutting tool is locked or kicked back.
- The main power button is turned on while the switch trigger is being pulled. In this situation, release the switch trigger and remove entangled weeds or debris if necessary. After that, pull the switch trigger again to resume.

Caution: If you need to remove the entangled weeds on the tool or release the locked cutting tool, be sure to turn the tool off before you start.

Over Temperature protection for tool or battery

If the tool or battery cartridge is overheated, the tool stops automatically. When the tool is overheated, the caution lamp lights up in red. When the battery cartridge is overheated, the caution lamp blinks in red. Let the tool and/or battery cool down before turning the tool on again.

Overdischarge protection

When the battery capacity becomes low, the tool stops automatically and the caution lamp starts blinking in red. If the tool does not operate even when the switches are operated, remove the battery cartridge from the tool and charge it.

KNOW YOUR PRODUCT

220211

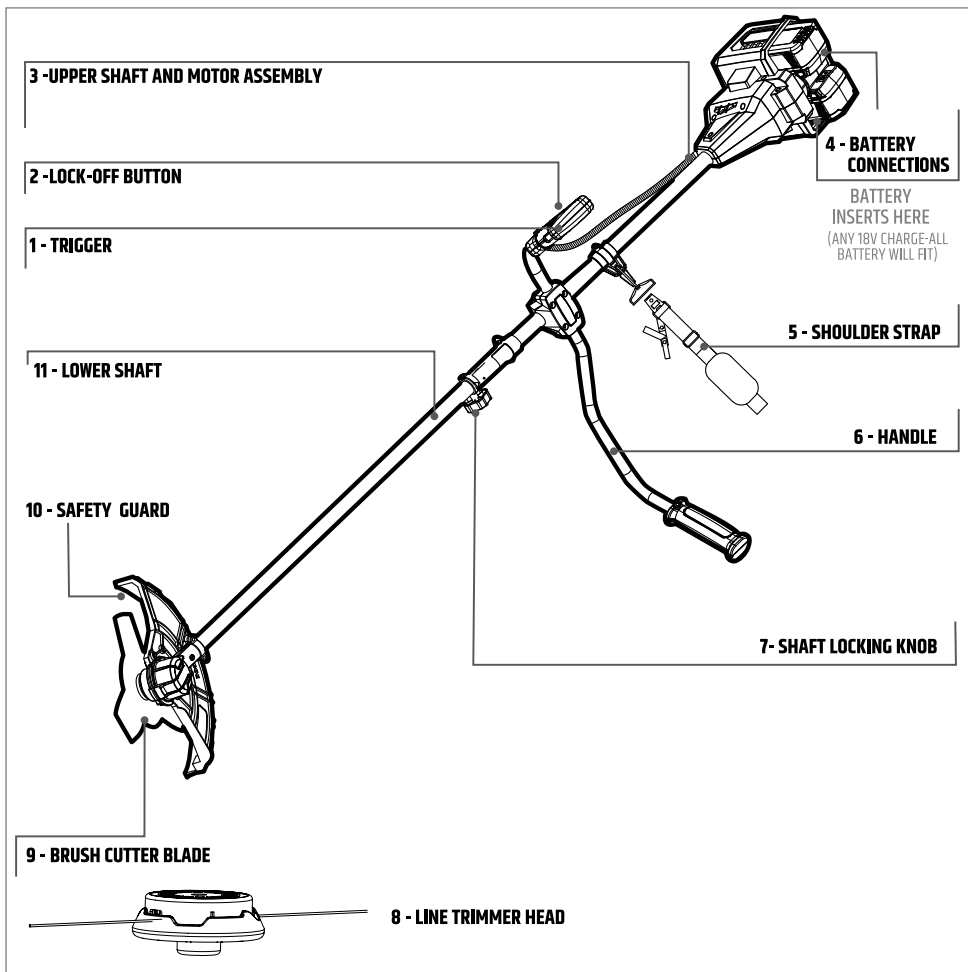

SPECIFICATIONS

Input Voltage:	36V (2 x 18V)
No-load speed:	5800 min ⁻¹
Cutting width (Brush Cutter):	255mm
Cutting width (Line Trimmer):	340mm
Cutting line size:	Ø1.6mm x 6m
Sound Pressure Level LpA (Brush Cutter)	79.1 dB(A)
Sound Pressure Level LpA (Line Trimmer)	83 dB(A)

Sound Power Level LWA (Brush Cutter)	88.4 dB(A)
Sound Power Level LWA (Line Trimmer)	92.5 dB(A)
Vibration Level (Brush Cutter)	1.35m/s ²
Vibration Level (Line Trimmer)	1.35m/s ²

ASSEMBLING THE HANDLE

220211

WARNING REMOVE BATTERY BEFORE PERFORMING ANY ADJUSTMENTS

WARNING! INSPECT THE AREA TO BE TRIMMED AND REMOVE ANY WIRE, CORD OR STRING-LIKE OBJECTS WHICH COULD BECOME ENTANGLED IN THE ROTATING SPOOL & LINE.

WARNING! ALWAYS USE BOTH HANDLES AT ALL TIMES.

WARNING! KEEP PROPER FOOTING AND BALANCE AT ALL TIMES AND BE SURE OF PROPER FOOTING ON SLOPES.

WARNING! DO NOT OPERATE THE TRIMMER ON A TREE, ON A LADDER, OR ON A SCAFFOLD. THIS IS EXTREMELY DANGEROUS.

CAUTION! BYSTANDERS MUST KEEP A MINIMUM SAFE DISTANCE OF 10M AWAY FROM THE TRIMMER WHILE IT IS OPERATING. STONES, PIECES OF METAL AND OTHER OBJECTS CAN BE THROWN OUT AT HIGH SPEED BY THE CUTTING LINE.

CAUTION! DO NOT CUT GRASS WHEN WET.

CAUTION! DO NOT BUMP THE HEAD ON ANY HARD SURFACES SUCH AS CONCRETE OR BRICK, THIS COULD CAUSE DAMAGE TO THE LINE TRIMMER.

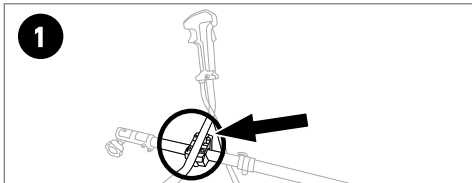

1. Install the handle into the lower half of the mounting bracket

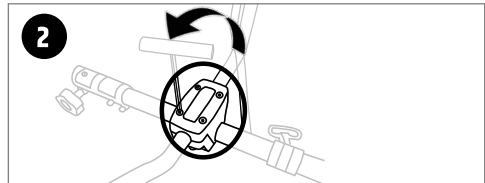

2. Replace the top half of the mounting bracket and tighten the four bolts with the socket and hex key, do not fully tighten the bolts until you have set the correct working position with the carrying strap.

ASSEMBLING THE GUARD

WARNING To prevent serious injury from flying debris install the guard only in the orientation shown

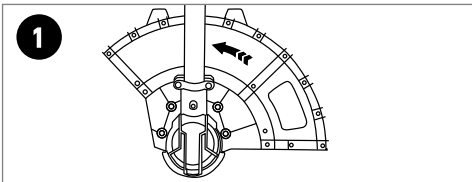

1. Remove the battery pack. Invert the grass trimmer to access the trimmer head. Place the guard on to the trimmer head so that the large part of the guard sits to the rear.

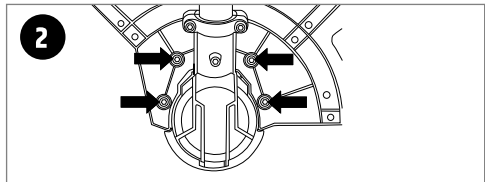

2. Align the 4 screw holes on the guard with the screw holes on the trimmer head. Tighten the four bolts with the socket and hex key.

INSTALLING THE DRIVE SHAFT ASSEMBLY TO THE UPPER SHAFT

WARNING Never install, remove, or adjust any attachment while power head is running. Failure to stop the motor can cause serious personal injury.

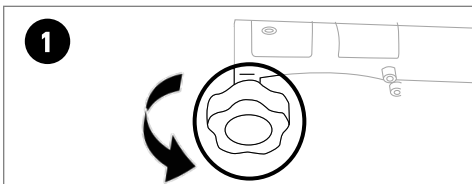

1. Loosen the locking knob on the connecting piece on the upper shaft. Carefully slide the lower shaft into the connecting piece on the upper shaft.

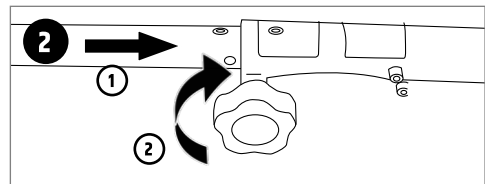

2. Ensure that the drive shafts on the insides of the shafts slide into each other (turn the spool head gently, if required) and then the lock on the lower shaft latches securely in the connecting piece hole.

ASSEMBLING THE BLADE

220211



WARNING

Never install, remove, or adjust any attachment while power head is running. Failure to stop the motor can cause serious personal injury.

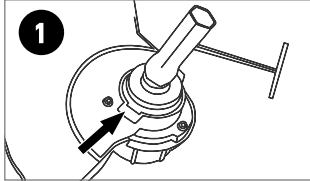

1. Press in the spindle button, and unscrew the locknut from the shaft by turning it clockwise with the socket and hex key.

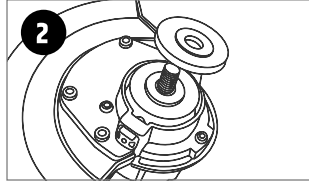

2. Remove the mounting disc.

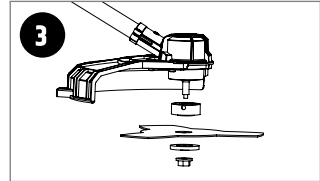

3. Position the blade as shown. Reinstall the mounting disc.

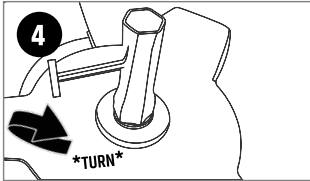

4. Screw down the locknut. Press in the spindle button and tighten the locknut by turning the socket and hex key anti clockwise.

ASSEMBLING THE LINE TRIMMER CUTTING HEAD



WARNING

Never install, remove, or adjust any attachment while power head is running. Failure to stop the motor can cause serious personal injury.

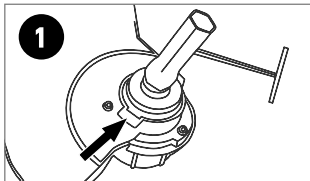

1. Press in the spindle button, and unscrew the locknut from the shaft by turning it clockwise with the socket and hex key.

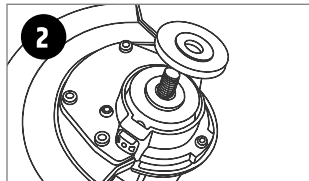

2. Remove the mounting disc.

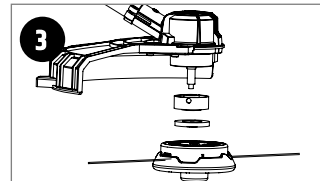

3. Ensure that the appropriate mounting accessories are in place.

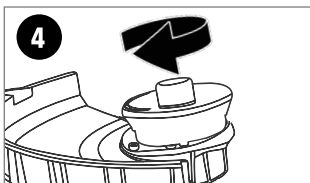

4. Lock the shaft by pressing the spindle lock button. Screw the line spool onto the shaft by turning it counterclockwise.

FITTING SHOULDER STRAP

220211

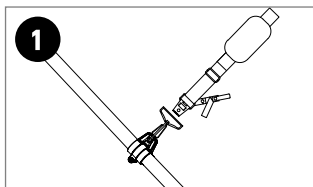

Fasten the carabiner hook to the shoulder strap bracket on the shaft.

LINE SPOOL REPLACEMENT



WARNING

Stop the tool and disconnect the battery. Line diameter: $\phi 1.6\text{mm} \times 6$

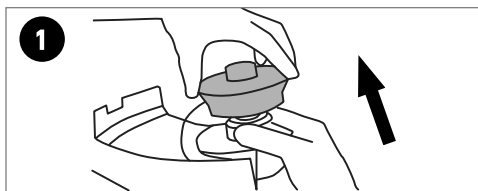

1. Press the release tabs on the line spool cover and remove the cover by pulling it straight off. Lift the spool out of the spool housing and clear any broken line or debris.

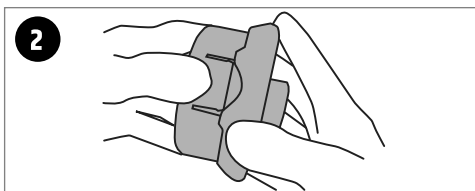

2. Remove the ends of the cutting lines and feed them into the eyelets. The line should protrude approximately 9cm from the spool housing.

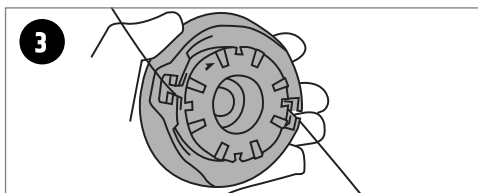

3. Attach the spool cover until the latches click into place. In case of jams and tangled line, unwrap about 15cm of line to ensure that it is undamaged. If it is OK, thread the end of the line spool through the eyelet in the spool cover.

ADVANCE THE CUTTING LINE

CAUTION

The line advances each time the knob is tapped, do not hold the knob on the ground.

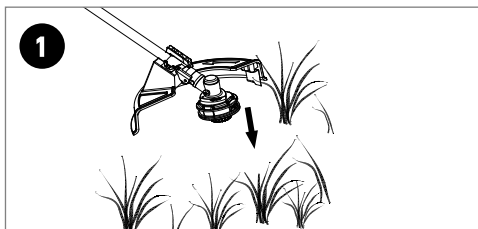

1. Run the line trimmer at full speed Tap the bump knob on hard, bare ground to advance line.

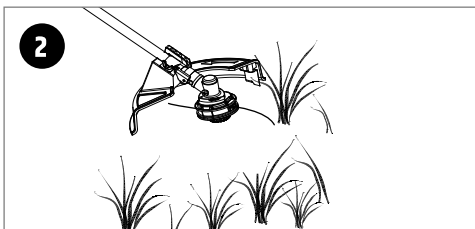

2. The bump feed will automatically lock once off the ground so that the line will stop feeding.

ADVANCE THE CUTTING LINE MANUALLY

220211

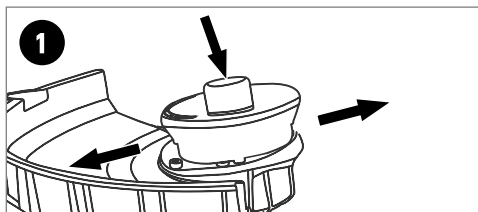

1. Push the spool bump knob down while pulling on cutting lines to manually advance the line.

HOW TO INSERT BATTERY ON TOOL

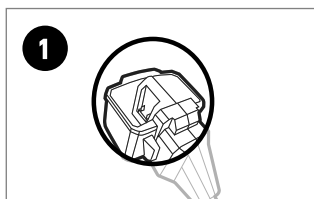

1. ALIGN BATTERIES RIBS WITH TOOL

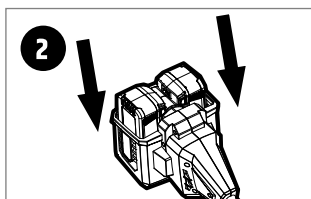

2. SLIDE INTO TOOL

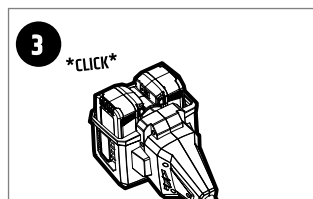

3. STOP WHEN YOU HEAR IT CLICK IN PLACE

OPERATION



WARNING READ AND UNDERSTAND ALL WARNINGS BEFORE OPERATING THIS TOOL.

STARTING/STOPPING



WARNING Before you start the unit, make sure that the line trimmer is not making contact with any objects.

CAUTION

Always allow 5 seconds or more for the cutting line/blade to stop rotating after releasing the trigger. Do not invert the grass trimmer, or place your hands under the protective guard until the line trimmer/brush cutter cutting line/blade has come to a complete stop.

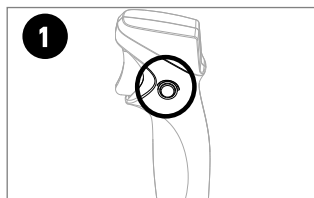

1. Push the Lock-off button.

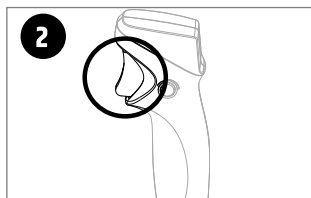

2. Pull the trigger, then release the lock-off button

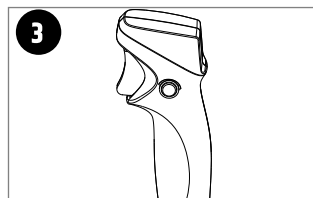

3. Release the On/Off trigger to stop the trimmer

CORRECT HANDLING OF THE TOOL

220211



WARNING

Always position the tool on your right-hand side. Correct positioning of the tool allows for maximum control and will reduce the risk of serious personal injury caused by kickback.

Be extremely careful to maintain control of the tool at all times. Do not allow the tool to be deflected toward you or anyone in the work vicinity. Failure to keep control of the tool could result in serious injury to the bystander and the operator.

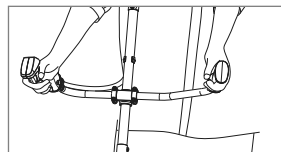

HOW TO USE THE LINE TRIMMER / BRUSH CUTTER



WARNING!

READ AND UNDERSTAND ALL WARNINGS BEFORE OPERATING THIS TOOL.



WARNING!

TO AVOID SERIOUS INJURY AND PROPERTY DAMAGE:

Before operating the gardening appliance, put on NSI approved safety goggles, closed toe work boots, long pants, and other safety gear. Inspect the area before using the line trimmer/brush cutter. Remove all hard objects from work area. Use both hands when operating the machine. Make sure that the On/Off trigger is in the Off position and remove the battery packs before setting up the appliance.

1



1. ENSURE SAFETY

Always wear safety glasses, gloves and boots when working with the line trimmer. Make sure to secure your hair and any baggy clothes. In appropriate situations make sure you wear ear muffs, a mask or a respirator mask.

2

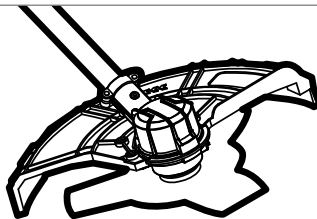

2. MAKE SURE MACHINE IS SET UP

Ensure the handle and shaft length are set up to be comfortable for use, the cutting blade is in the desired position or there is enough line in the spool.

3

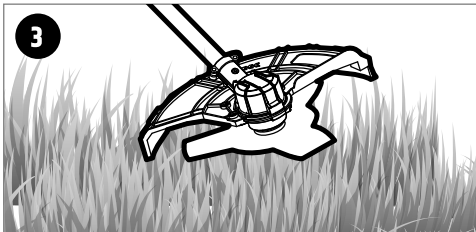

3. BEGIN TO CUT GRASS

To use the machine, start with the line away from the cutting area. Pull the trigger (2) and move the machine towards the grass you are trying to cut.

4

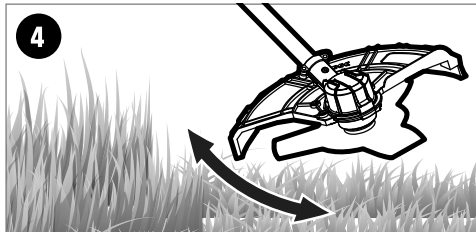

4. SEVERAL PASSES MAY BE REQUIRED

Use a sweeping motion side to side to cut the grass. Multiple passes may be required to completely cut the grass.

HOW TO USE THE LINE TRIMMER

220211

CAUTION

Inspect machine for damage upon striking a hard object or if there appears to be excessive vibration.

TRIMMING

For the most effective grass trimming, ensure the tool is operating at full speed and then use slow shallow sweeps of the line, ensuring that you do not overload the tool by cutting too fast or cutting through heavy terrain.

Make sure that the work area is free of rock, debris, lines and other foreign objects.

Start the tool before approaching the grass to be cut. Cut the grass by swinging the tool from right to left and proceed slowly keeping the trimmer inclined forwards at an angle of about 30°. Light cuts are better than heavy cuts as they allow the cut grass to fall away from the spool preventing the grass from clogging the spool.

High grass should be cut in layers always beginning from the top. Do not cut damp or wet grass. Do not overload your tool.

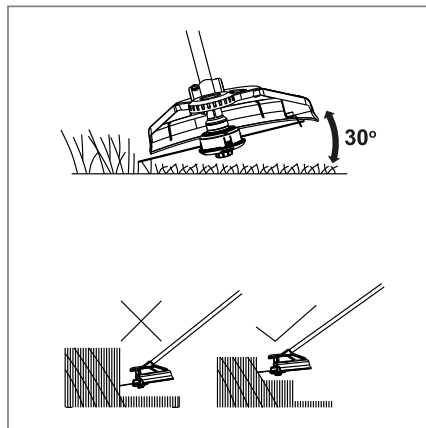

MAINTENANCE



WARNING!

To prevent accidental starting that could cause serious personal injury, always remove the battery packs from the product before adjusting, inspecting, or cleaning. Never disassemble the tool or carry out any repairs. Always have the trimmer and charger maintained or repaired by a competent person at an authorized service centre.

CLEANING

Remove the battery packs. Brush or blow dust and debris out of the air vents using compressed air or a vacuum. Keep the air vents free of obstructions, sawdust, and wood chips. Do not spray, wash, or immerse the air vents in water.

Wipe off the housing and the plastic components using a moist, soft cloth. Do not use strong solvents or detergents on the plastic housing or plastic components that may cause damage.

STORAGE

Clean the tool thoroughly before storing. Store the tool in a dry, well-ventilated area that is inaccessible to children. Keep away from corrosive agents such as garden chemicals and de-icing salts. Always place blade cover on cutting blades before storing. Store and charge your batteries in a cool area.

Temperatures above or below normal room temperature will shorten battery pack life.

Never store batteries in a discharged condition. Wait for battery pack to cool and fully charge immediately.

All batteries gradually lose their charge. The higher the temperature, the quicker they lose their charge. If you store your unit for long periods of time without using it, recharge the batteries every month or two. This practice will prolong battery pack life.

SYMBOLS

220211

The rating plate on your tool may show symbols. These represent important information about the product or instructions on its use.

	Direct current, DC		Waste electrical products should not be disposed of with household waste. Please recycle where facilities exist. Check with your Local Authority or retailer for recycling advice
	Refer to instruction manual/booklet		
	Wear ear, eye and head protection		General warning
	Wear hand protection		Regulator compliance mark
	Wear feet protection		Indoor use only
	Beware of thrown objects		Do not use metal filament lines
	Keep bystanders away		Beware of thrown objects hit by cutting attachments. Never use without properly mounting the blade guard
	WARNING! The distance between the machine and by standers shall be at least 15m.		Do Not expose to rain

KATANA[®]

Australia & Global

www.katanapowertools.com.au

enquiries@katanapowertools.com.au

+61 3 9730 7100

Made to Katana specifications and quality standards in China.

NOT INTENDED FOR TRADE USE

5 YEAR WARRANTY*

* All Katana power tools come with a 5 year (3+2 year) replacement warranty from date of purchase.

3 year standard warranty with the option to register your product online at www.katanapowertools.com.au/ register to receive an additional 2 years free of charge.

Products must be registered within 30 days from date of purchase to qualify for warranty extension.

Kincrome guarantees Katana products against faulty workmanship and materials. Kincrome will, at their discretion replace faulty products free of charge. This guarantee does not cover product that has been altered, misused, abused, subjected to normal wear and tear, used for commercial or trade use or not used in accordance with product guidelines.

Warranty is given by Kincrome Australia Pty Ltd of 3 Lakeview Drive, Caribbean Park, Scoresby, Victoria (Tel 1300 657 528). If this product has materials or workmanship defects (other than defects caused by abnormal or non-warranted use) you can, at your cost, send the product to the above address for replacement. Your rights under this warranty are in addition to any other rights you have under the Australian Consumer Law or other applicable laws. Kincrome goods come with guarantees that cannot be excluded under the Australian Consumer Law. You are entitled to a replacement or refund for a major failure.